



1845 ST. MATTHEWS AVENUE FOR LEASE

1845 St. Matthews Ave.
Winnipeg, MB

~Approximately 20,049 sq. ft.

\$14,201.38 per month net
(plus Goods & Services Taxes (GST))

For more information:

Graeme T. Rowswell
President

G.T. Rowswell Realty Leasing Co.
Suite 300, 460 Main Street
Winnipeg, MB. R3B 1B6
(office) 204.957.1834
(mobile) 204.981.7455
(fax) 204.943.8696
rowswell@mymts.net
www.rowswellrealty.com





FOR LEASE

LOCATION:	1845 St. Matthews Street
AREA:	Approximately 20,049 square feet
TENANT'S RESPONSIBILITIES:	Rent. Hydro. Heat. Water. Janitor service & waste disposal. Pro rata share of grounds maintenance & snow removal. Realty taxes. Normal maintenance & repair including Heating and Air Conditioning. Building insurance & extended coverage Lighting replacement. Management & Supervisory Fee.
LANDLORD'S RESPONSIBILITIES:	Structural Repairs - roof deck, exterior walls (excluding glass), floor (excluding floor covering), and building foundation.
RENTAL:	\$8.50 per sq. ft. per annum net or \$14,201.38 per month net, plus Goods and Services Tax (GST) .
REQUIRED DEPOSIT:	3 months base rent to be applied towards the first and last months rental plus one months damage deposit.
ADDITIONAL COSTS:	Monthly: Realty Taxes \$2,752.51 Management \$910.19 Insurance \$1,250.00
LEASE TERM:	5 Years
POSSESSION:	Arranged
ZONING:	M1
FEATURES:	Approximately 25% of premises is developed office. Ceiling height of 12 ft. 2 Grade level OHD 8' X 10' and 8' X 8'.
PARKING:	15 stalls at rear of property



FOR LEASE - 1845 St. Matthews Avenue



The information contained herein has been derived from data supplied by the Owner, the municipality or city, and other such sources deemed to be reliable. However, G.T. Rowswell Realty Leasing Co., does not guarantee the adequacy or accuracy and assumes no responsibility for errors or omissions. You are relying on your own enquiries and inspection. The information has been received and is being provided in good faith. There is no warranty, either expressed or implied by the Owner or G.T. Rowswell Realty Leasing Co., in any regard whatsoever, including but not limited to any soil or subsurface conditions and the absence of all toxic materials including but not limited to UFFI and asbestos. Prospective buyers should consult their legal counsel, accountant or other advisors on matters related to the Property and this information. This submission is made subject to prior lease, sale, exchanges, change in price or terms, or withdrawal from sale without notice.



FOR LEASE - 1845 St. Matthews Avenue





FOR LEASE - 1845 St. Matthews Avenue





FOR LEASE - 1845 St. Matthews Avenue

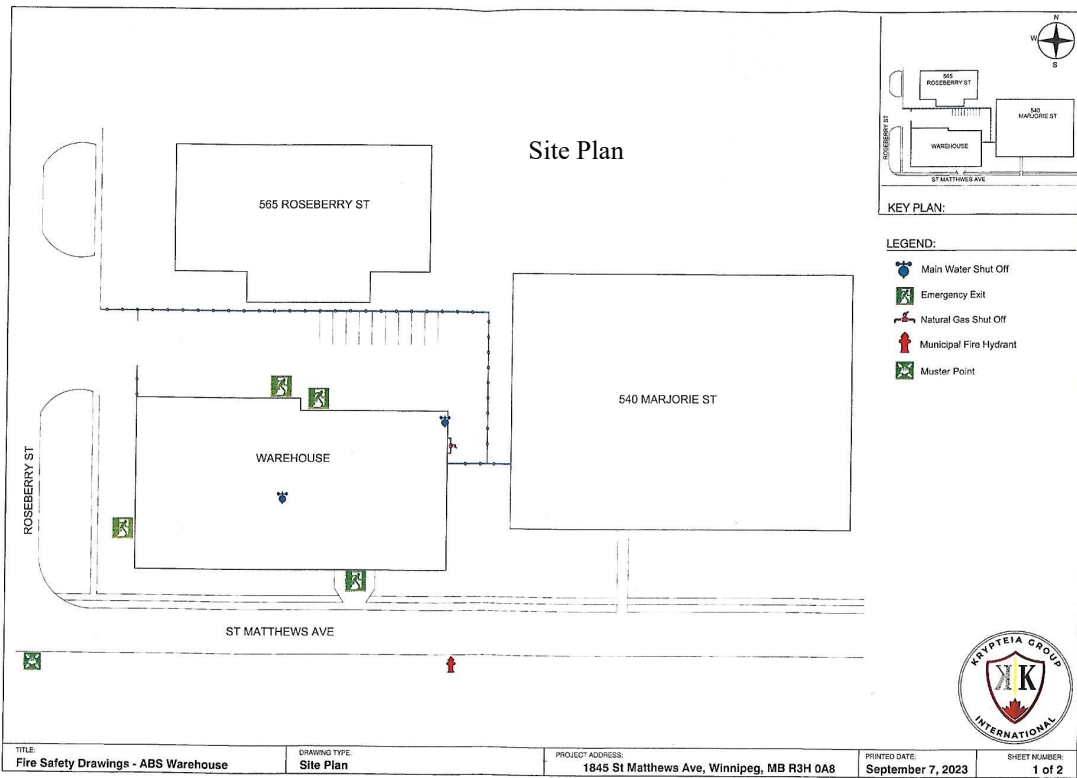
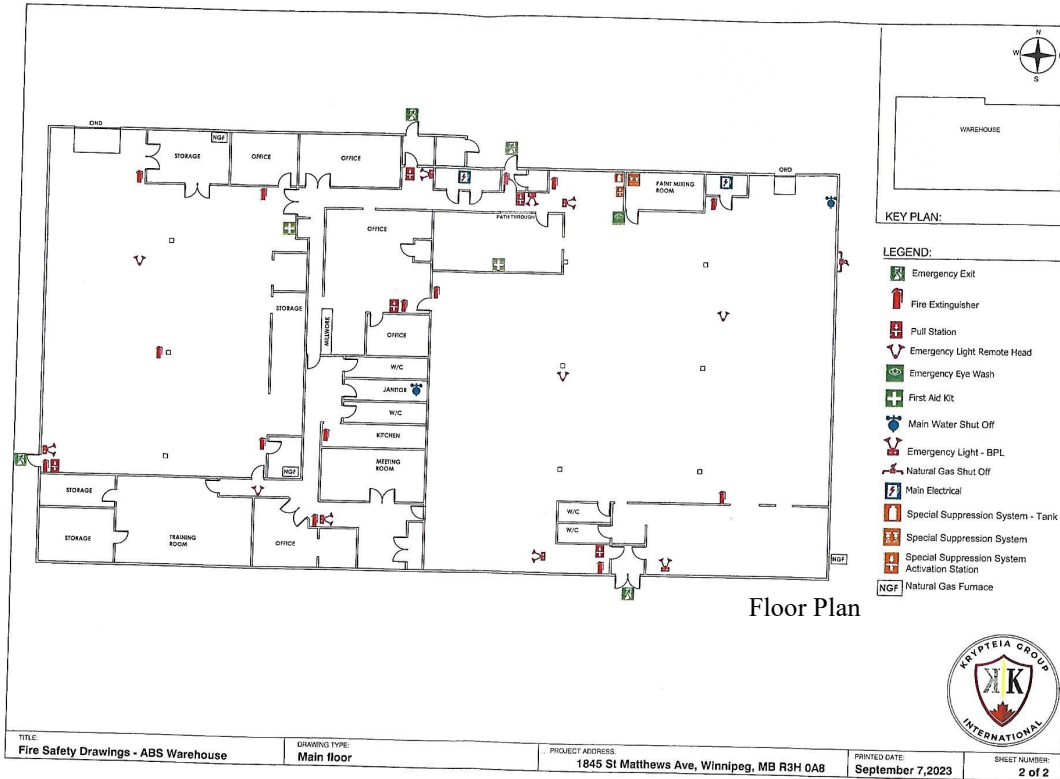



1845 St. Matthews Avenue

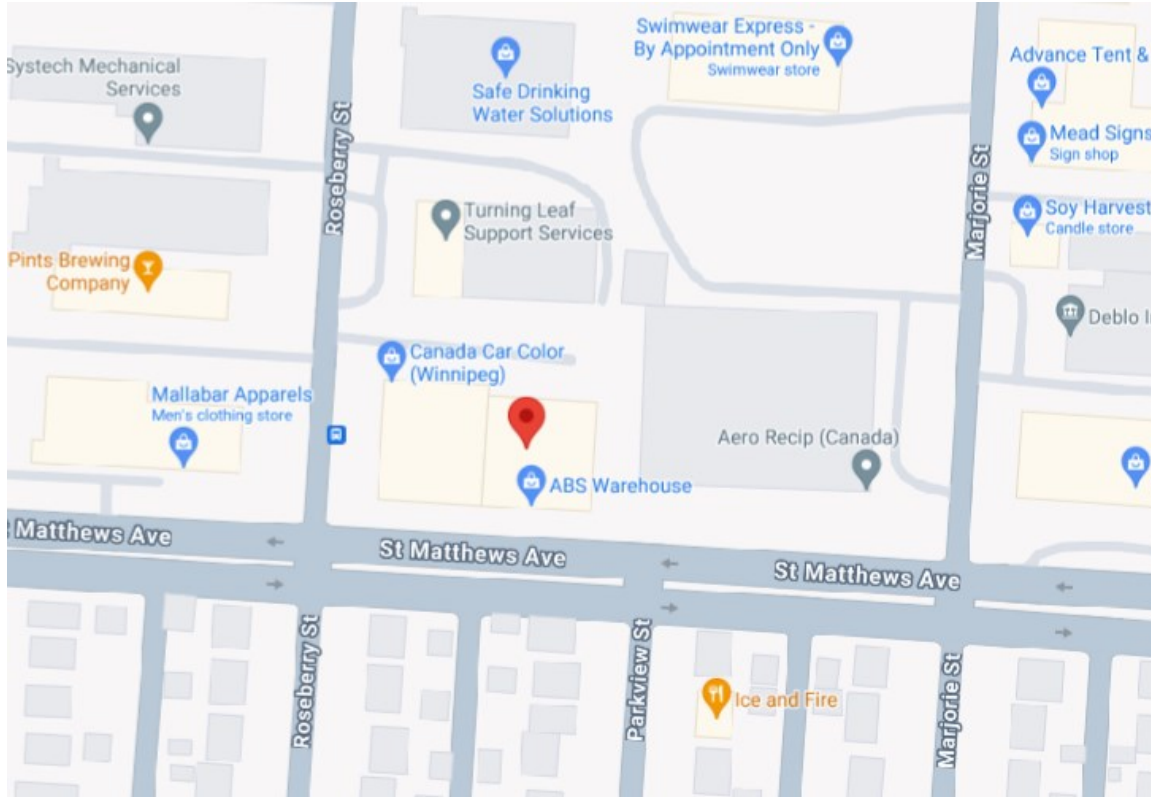

FEATURES

Approximately 25% of premises is developed office.
Ceiling height of 12 ft. 2 Grade level OHD 8' X 10' and 8' X 8'.

The information contained herein has been derived from data supplied by the Owner, the municipality or city, and other such sources deemed to be reliable. However, G.T. Rowswell Realty Leasing Co., does not guarantee the adequacy or accuracy and assumes no responsibility for errors or omissions. You are relying on your own enquiries and inspection. The information has been received and is being provided in good faith. There is no warranty, either expressed or implied by the Owner or G.T. Rowswell Realty Leasing Co., in any regard whatsoever, including but not limited to any soil or subsurface conditions and the absence of all toxic materials including but not limited to UFFI and asbestos. Prospective buyers should consult their legal counsel, accountant or other advisors on matters related to the Property and this information. This submission is made subject to prior lease, sale, exchanges, change in price or terms, or withdrawal from sale without notice.